



VIEW OF PARK OFFICE



**PARK HOURS**  
8 A.M. - SUNSET,  
SEVEN DAYS A WEEK.

*(contact the park for seasonal closing times)*

**TELEPHONE**  
**(919) 662-2850**



**CROWDER DISTRICT PARK**  
**IS CLOSED**  
THANKSGIVING DAY  
CHRISTMAS EVE  
CHRISTMAS DAY  
NEW YEAR'S DAY

Safety and enjoyment go hand in hand at Crowder District Park. The following regulations have been established to ensure a safe and pleasant visit.

1. **SPEED LIMIT IS 20 MPH.**
2. **PETS MUST BE RESTRAINED WITH A 6' LEASH AT ALL TIMES.**
3. **WOOD FIRES ARE NOT ALLOWED; USE PARK GRILLS ONLY.**
4. **PARK ONLY IN DESIGNATED AREAS.**  
*No parking on roadsides or outside park gates.*
5. **THE FOLLOWING ARE PROHIBITED:**
  - a. *Alcoholic beverages.*
  - b. *Firearms.*
  - c. *Hunting.*
  - d. *Overnight camping.*
  - e. *Swimming/Wading.*
  - f. *Collection, removal, or release of any animal, plant or mineral material.*
  - g. *Amplified music.*
  - h. *Feeding wildlife.*
  - i. *Littering.*

Help keep our parks beautiful. Place trash and recycling in the appropriate containers.

Learn more about other parks operated by Wake County Parks, Recreation, and Open Space.

Information is available at park office, in our brochures or you can visit us at:  
*www.wakegov.com*

**CROWDER DISTRICT PARK**  
4709 TEN-TEN ROAD  
APEX, NC 27539  
**(919) 662-2850**

**CROWDERDISTRICTPARK@CO.WAKE.NC.US**

Printed on recycled paper. LA-10/06



# CROWDER DISTRICT PARK



# CROWDER DISTRICT PARK

## A DAY AT CROWDER DISTRICT PARK

*A day at Crowder District Park provides a variety of educational and recreational activities for all ages.*

*Park naturalists offer interpretive, hands-on environmental programs for groups of all ages and interests, as well as outreach programs for organized community groups.*

*The park's 33 acres provide recreational opportunities that include over one mile of paved trails, an open play field, sand volleyball, outdoor amphitheater and three picnic shelters with adjacent playgrounds.*

*The park's 2.7 acre pond is always a favorite stop while at Crowder.*



### PICNICKING AND SHELTERS

There are three covered picnic shelters and several picnic tables located throughout the park. Each of the covered shelters has a large charcoal grill with restroom facilities and playgrounds nearby. Shelter reservations can be made by calling the park office at (919) 662-2850. Unreserved shelters may be used free of charge on a first-come, first-served basis. Users are expected to leave the shelter and surrounding areas clean and undamaged.

#### PICNIC SHELTER FEES

*(A \$50.00 security deposit is required for each shelter rented, and will be refunded if shelters are left clean and undamaged.)*

##### HERON SHELTER (100 person maximum)

Daily (9 A.M. - closing) \_\_\_\_\_ \$80.00

##### CARDINAL SHELTER (50 person maximum)

Daily (9 A.M. - closing) \_\_\_\_\_ \$60.00

##### ROBIN SHELTER (25 person maximum)

Daily (9 A.M. - closing) \_\_\_\_\_ \$40.00



### RECREATION AND LEISURE

A visit to Crowder offers patrons a chance to relax in a natural setting that offers passive recreational and educational activities for all ages.

#### • Paved Trails

*Take a relaxing stroll along accessible trails that wind through the wooded areas of the park and circle Crowder Pond.*

#### • Open Play Field

*Enjoy an invigorating afternoon of frisbee, kite-flying, ball playing or sand volleyball.*

#### • 2.7 Acre Pond

*Observe waterfowl, amphibians and numerous reptiles from our boardwalk.*

#### • Park Pavilion

*Discover nature through our interpretive display. Relax as you watch birds at the feeders, or sit quietly and read a good book on the observation deck. Please no food, drinks, or smoking in this area.*

#### • Educational Gardens

*Check out the various gardens located throughout the park. The gardens provide ideas for native planting and backyard wildlife habitats.*

#### • Playgrounds

*There are three playgrounds at Crowder, the largest is located near the upper restroom pavilion and has play equipment for elementary school age and small children. The other two playgrounds are located near the Heron and Robin picnic shelters and are best suited for small children. All are located near parking.*

#### • Fishing Pier

*Youth fishing is permitted at Crowder District Park. This activity is for youth under the age of 16. Fishing is allowed on the pier only. **NO** shoreline fishing or fishing from the boardwalk is allowed.*

#### • Outdoor Amphitheater

*The wooded amphitheater provides the perfect setting for programs and performances. It seats about 50 people and has a wooden platform "stage" area with two built in tables.*

## Discovering...

# CROWDER DISTRICT PARK

## THE HISTORY

In 1992 Mrs. Doris Crowder donated 33 acres of land to Wake County, with the stipulation that the land be used as a public recreational facility. With two million dollars from the 1992 Parks Bonds Referendum, planners were able to move quickly to transform this heavily wooded tract of land into a fully operational park.

During development of the park, on September 15<sup>th</sup>, 1996, Hurricane Fran hit the triangle. The park experienced significant damage with nearly 50% of the trees destroyed.

Crowder District Park opened to the public in June of 1998. The park offers three picnic shelters, three playgrounds, a sand volleyball court, 2.7 acre pond, open-play field including a backstop for pick-up games, paved trails, and restroom facilities. The park also provides environmental education programs throughout the year.



## FREQUENTLY ASKED QUESTIONS

### What is the length of the paved trails?

The outer paved loop is 0.8 miles. The loop around the perimeter of the pond measures 0.3 miles.

### Does the park provide pet waste disposal bags?

Yes. Pet waste disposal bags are glove-like plastic baggies to be used as disposable bags for your dog's feces. These are provided at several locations along the paved trails. Proper disposal of dog waste will help eliminate the spread of bacteria, parasites and viruses which can be harmful to water quality and human health. If left on the ground, not only can it be stepped in by other park visitors, but can become a source of contamination to the pond.

### Can I release my bird, fish, turtle, etc. into the park?

NO! The release of any wildlife into the park is not allowed. Please contact your local Wildlife Commission Office for more information on animal rehabilitation and surrender or talk to a park staff member.

### Is the snake that is down by the pond poisonous?

Most likely you are seeing a Northern Water Snake in or by the pond. This species of snake is not poisonous, and is very beneficial to the ecosystem of the park. Park staff are available to answer any questions about wildlife seen in Crowder park.

### Can I volunteer at the park?

Yes! There are many volunteer opportunities ranging from a few hours for a single person, to organized projects for groups. New ideas for projects are always welcome, but must be approved by park staff. For more information please contact the Assistant Park Manager at 662-2852.



**W**hen planning began in 1992 for Crowder District Park, an open natural area for family recreational outings was of utmost importance.

*There are opportunities for visitors to relax and enjoy their day at Crowder. Park visitors are asked to review the "PARK USERS' ETHICS AND RESPONSIBILITIES" outlined below before beginning any activities.*

## TRAIL USER ETHICS AND RESPONSIBILITIES

- 1. SET A GOOD EXAMPLE.** The success and safety of this park depends on the users. Practice good park ethics—report any improper activities or hazards to park staff immediately.
- 2. LEAVE NO LITTER.** Please keep the playgrounds, shelters, open field, parking lots and trails clean and free of litter. Use the trash and recycling containers located throughout the park to properly dispose of food or straw wrappers, drink containers, napkins, cigarette butts and other waste. Pick up and properly dispose of dog feces.
- 3. STAY ON PAVED TRAILS.** The plants along Crowder pond's shoreline are crucial for controlling erosion and catching pollutants before they enter the water. Help preserve the beauty and integrity of Crowder's pond by remaining on paved trails.
- 4. BE MINDFUL OF OTHER USERS.** Respect the rights of all other trail users and obey all park rules and regulations. Show courtesy when passing other trail users, especially when approaching from behind. Bikers, skaters and joggers must reduce speed near all blind spots and always yield to walkers.
- 5. DO NOT FEED THE WILDLIFE.** Turtles, waterfowl and fish live in Crowder's pond. Their natural diet consists of aquatic plants and insects. Feeding wild animals will upset nature's balance, can make them sick as well as more dependent on human type food. **PLEASE DO NOT FEED ANY ANIMALS WHILE AT THE PARK.**
- 6. BEWARE OF NATURAL HAZARDS.** Keep in mind this is a natural environment. Poison ivy, briars, and abundant wildlife call the park home. Always stay on the trails and observe wildlife from a distance.
- 7. ALLOW TIME TO FINISH ACTIVITIES BEFORE PARK CLOSING TIME.** Please take note of closing time when you arrive at the park. A sign at the entrance to the park shows when the park closes. Allow adequate time to finish walks, cookouts, and cleanup before the park closes.

# CROWDER DISTRICT PARK

## MAP LEGEND

- AMPHITHEATER TRAIL ---
- OUTER PAVED TRAIL —
- INNER PAVED TRAIL —
  
- CARDINAL SHELTER 1
- ROBIN SHELTER 2
- HERON SHELTER 3
- RESTROOMS ▲
- PLAYGROUND/PICNIC AREAS P
- VOLLEYBALL COURT V
- AMPHITHEATER
- EDUCATIONAL GARDENS ★

These maps of Crowder District Park are not drawn to scale.

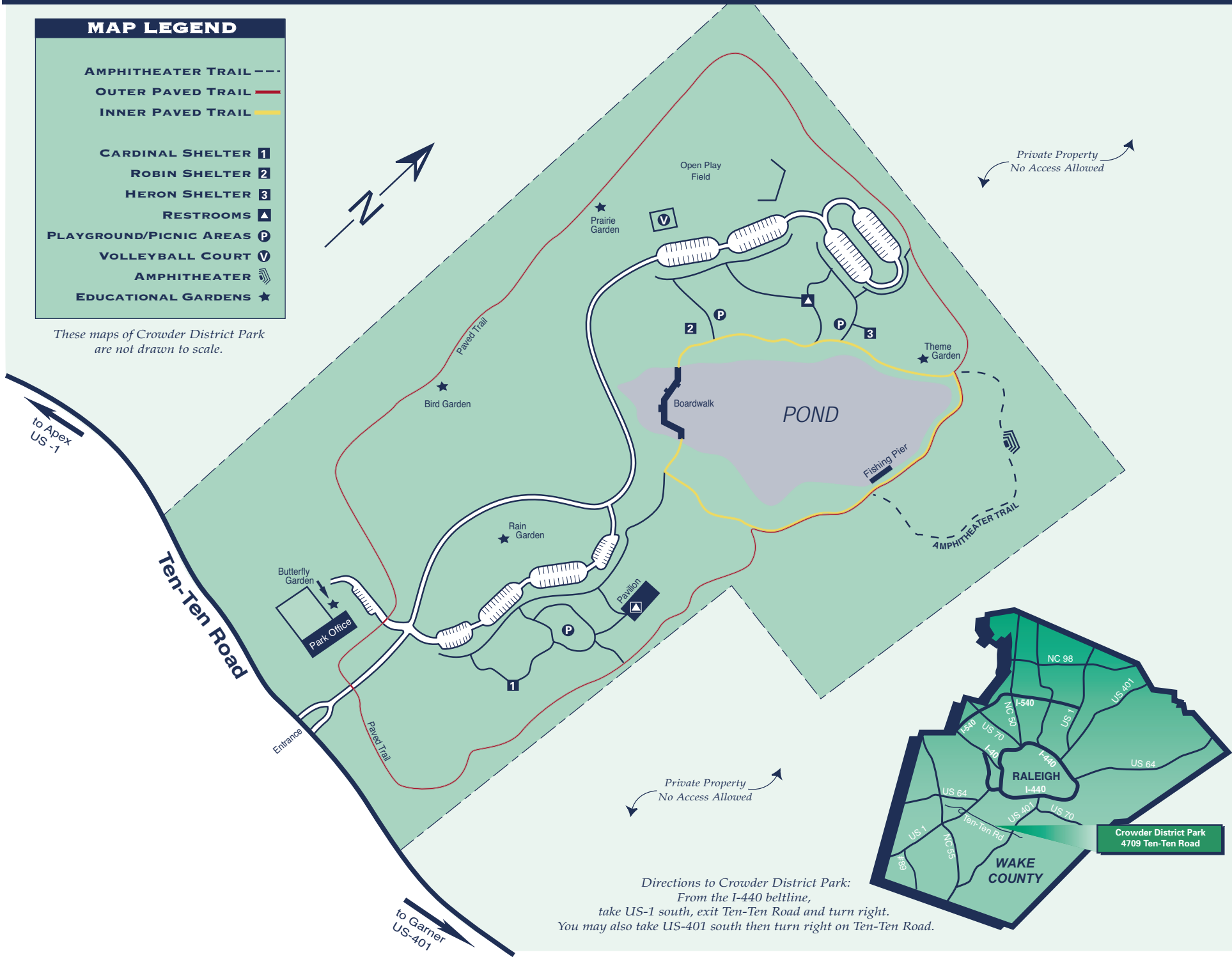

Private Property  
No Access Allowed

Private Property  
No Access Allowed

Directions to Crowder District Park:  
From the I-440 beltline,  
take US-1 south, exit Ten-Ten Road and turn right.  
You may also take US-401 south then turn right on Ten-Ten Road.

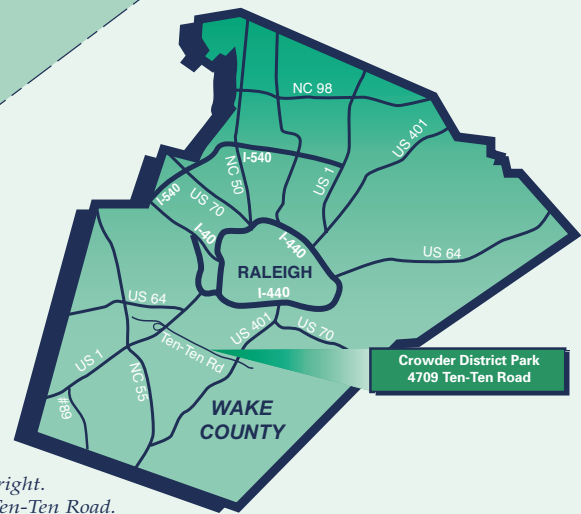

Crowder District Park  
4709 Ten-Ten Road